

**KITO CROSBY** is the global leader of the lifting and securement industry it pioneered, and for which it continues to set the quality standard. With global engineering, manufacturing, distribution, and operations, the company provides a broad range of products and solutions for the most demanding applications. Our iconic brands include Kito, Crosby, Harrington, Gunnebo Industries, and Peerless. Kito Crosby’s people, products, solutions, and service have innovated the lifting and securement industry for more than 250 years. Together we lift and secure the world today, for a safer, stronger, and more productive tomorrow.

# Crosby®

The Crosby brand has been trusted for hundreds of years. As the world’s leading manufacturer for rigging, lifting, and material handling applications, Crosby delivers the industry’s most comprehensive portfolio of products, engineered to exceed the toughest demands. We serve the land-based and offshore energy, construction and infrastructure, cargo handling and towing, marine, mining, and transportation industries. Our products of uncompromising quality include Red Pin® shackles, hooks, wire rope clips and end fittings, chain slings and accessories, hoist rings, master links, lifting clamps, turnbuckles, snatch blocks, crane blocks, sheaves, load binders, hoists, mooring components and a host of other custom-engineered solutions.

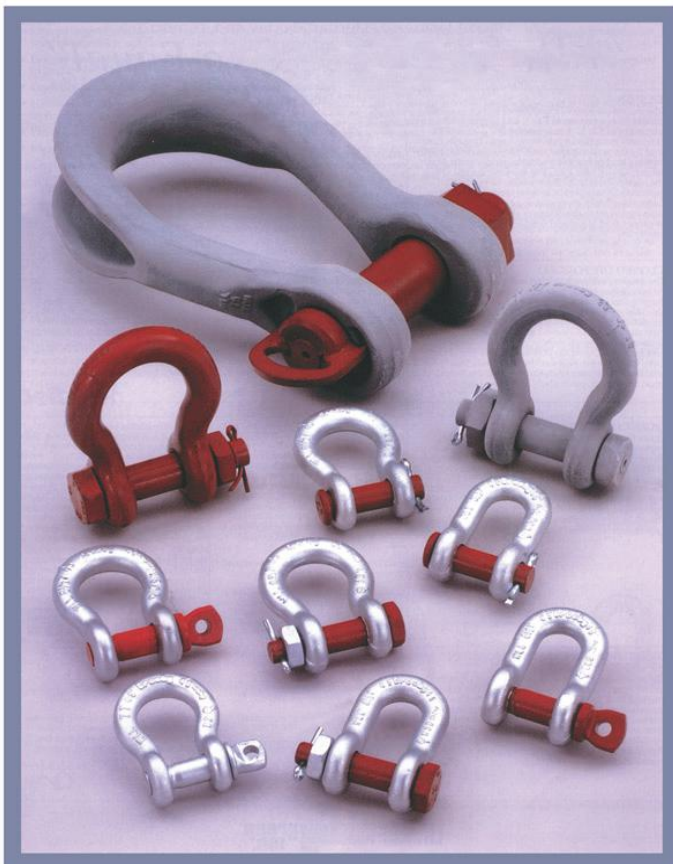

Crosby shackles



Crosby Travelling Blocks



Crosby Rigging hardwares

## Crosby® Bolt Type Shackles



**G-2130 / S-2130**  
Bolt Type Anchor shackles with thin head bolt - nut with cotter pin. Meets the performance requirements of Federal Specification RR-C 271G Type IVA, Grade A, Class 3, except for those provisions required of the contractor. For additional information, see page 475.

- Capacities 1/3 thru 150 metric tons, grade 6.
- Working Load Limit and grade "6" permanently shown on every shackle.
- Forged – Quenched and Tempered, with alloy bolts.
- Hot Dip galvanized or self colored. (85, 120, and 150 metric ton shackles are all hot dip galvanized bows and the bolts are Dimetcoated® and painted red)
- Sizes 3/8 and below are mechanically galvanized.
- Fatigue rated (1/3t - 55t).
- Shackles 25t and larger are **RFID EQUIPPED**.
- Approved for use at -40° C (-40° F) to 204° C (400° F).
- Meets or exceeds all requirements of ASME B30.26.
- Shackles 85 metric tons and larger are individually proof tested to 2.0 times the working load limit.
- Type Approval certification in accordance with ABS 2016 Steel Vessel Rules ABS Guide for Certification of Lifting Appliances available. Certificates available when requested at time of order and may include additional charges.
- 3.1 Certification as standard available for charpy and statistical proof test from 3.25t up to 25 tons to DNV2.7-1 and EN13889.
- Crosby 3.25t through 25t G2130OC anchor shackles are type approved to DNV Certification Notes 2.7-1- Offshore Containers. These Crosby shackles are statistical proof and impact tested to 42 Joules (31 ft•lbf) min. avg. at -20° C (-4° F). The tests are conducted by Crosby and 3.1 test certification is available upon request. Refer to page 87 for Crosby COLD TUFF® shackles that meet the additional requirements of DNV rules for certification of lifting applications - Loose Gear.
- All other 2130 shackles can meet charpy requirements of 42 Joules (31 ft•lbf) avg at -20° C (-4° F) when requested at time of order.
- Look for the Red Pin® . . . the mark of genuine Crosby quality.

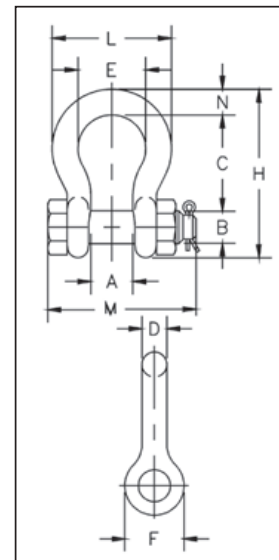

Shackles



**SEE APPLICATION INFORMATION**  
On Page 92 of the General Catalog  
Para Español: [www.thecrosbygroup.com](http://www.thecrosbygroup.com)

### G-2130 / S-2130 Bolt Type Anchor Shackles

Nominal Size (in)	Working Load Limit (t)*	Stock No.			Weight Each (kg)	Dimensions (mm)											Tolerance +/-	
		G-2130	S-2130	G-2130OC		A	B	C	D	E	F	H	L	M	N	C	A	
3/16	1/3 ‡	1019464	—	—	.03	9.65	6.35	22.4	4.85	15.2	14.2	37.3	24.9	32.8	4.85	1.50	1.50	
1/4	1/2	1019466	—	—	.05	11.9	7.85	28.7	6.35	19.8	15.5	46.7	32.5	39.6	6.35	1.50	1.50	
5/16	3/4	1019468	—	—	.10	13.5	9.65	31.0	7.85	21.3	19.1	53.0	37.3	46.2	7.85	1.50	1.50	
3/8	1	1019470	—	—	.15	16.8	11.2	36.6	9.65	26.2	23.1	63.0	45.2	55.1	9.65	3.30	1.50	
7/16	1-1/2	1019471	—	—	.22	19.1	12.7	42.9	11.2	29.5	26.9	74.0	51.5	63.8	11.2	3.30	1.50	
1/2	2	1019472	1019481	—	.36	20.6	16.0	47.8	12.7	33.3	30.2	83.5	58.5	71.1	12.7	3.30	1.50	
5/8	3-1/4	1019490	1019506	1262013	.62	26.9	19.1	60.5	16.0	42.9	38.1	106	74.5	90.4	17.5	3.30	1.50	
3/4	4-3/4	1019515	1019524	1262022	1.23	31.8	22.4	71.5	19.1	51.0	46.0	126	89.0	105	20.6	6.35	1.50	
7/8	6-1/2	1019533	1019542	1262031	1.79	36.6	25.4	84.0	22.4	58.0	53.0	148	102	122	24.6	6.35	1.50	
1	8-1/2	1019551	1019560	1262040	2.28	42.9	28.7	95.5	25.4	68.5	60.5	167	119	137	26.9	6.35	1.50	
1-1/8	9-1/2	1019579	1019588	1262059	3.75	46.0	31.8	108	28.7	74.0	68.5	190	131	150	31.8	6.35	1.50	
1-1/4	12	1019597	1019604	1262068	5.31	51.5	35.1	119	31.8	82.5	76.0	210	146	170	35.1	6.35	1.50	
1-3/8	13-1/2	1019613	1019622	1262077	7.18	57.0	38.1	133	35.1	92.0	84.0	233	162	183	38.1	6.35	3.30	
1-1/2	17	1019631	1019640	1262086	8.62	60.5	41.4	146	38.1	98.5	92.0	254	175	196	41.1	6.35	3.30	
1-3/4	25	1019659	1019668	1262095	15.4	73.0	51.0	178	44.5	127	106	313	225	246	57.0	6.35	3.30	
2	35	1019677	1019686	—	23.7	82.5	57.0	197	51.0	146	122	348	253	275	61.0	6.35	3.30	
2-1/2	55	1019695	1019702	—	44.6	105	70.0	267	66.5	184	145	453	327	345	79.5	6.35	6.35	
3	† 85	1019711	—	—	70	127	82.5	330	76.0	200	165	546	365	384	92.0	6.35	6.35	
3-1/2	† 120 ‡	1019739	—	—	120	133	95.5	372	92.0	229	203	626	419	432	105	6.35	6.35	
4	† 150 ‡	1019757	—	—	153	140	108	368	104	254	229	653	468	451	116	6.35	6.35	

\* NOTE: Maximum Proof Load is 2 times the Working Load Limit. Minimum Ultimate Strength is 6 times the Working Load Limit. For Working Load Limit reduction due to side loading applications, see page 94. † Individually Proof Tested with certification. ‡ Furnished in Anchor style only and furnished with eyebolts for handling.

## Jaw & Jaw Turnbuckles



Eye & Eye  
HG - 226

Jaw & Eye  
HG - 227

Jaw & Jaw  
HG - 228

- End fittings are Quenched and Tempered or Normalized, bodies heat treated by normalizing.
- Hot Dip galvanized steel.
- TURNBUCKLES RECOMMENDED FOR STRAIGHT OR IN-LINE PULL ONLY .
- Forged jaw ends are fitted with bolts and nuts for 1/4" through 5/8", and pins and cotters on 3/4" through 2-3/4" sizes.
- Modified UNJ thread on end fittings for improved fatigue properties
- Body has UNC threads.
- Lock Nuts available for all sizes (see page 198).
- Comprehensive end fitting data provided on page 196.
- Fatigue Rated.
- Meets or exceeds all requirements of ASME B30.26 including identification, ductility, design factor, proof load and temperature requirements. Importantly, these turnbuckles meet other critical performance requirements including fatigue life, impact properties and material traceability, not addressed by ASME B30.26.

Meets the performance requirements of Federal Specifications FF-791b, Type 1 Form 1 - CLASS 7, and ASTM F-1145, except for those provisions required of the contractor. For additional information, see page 452.

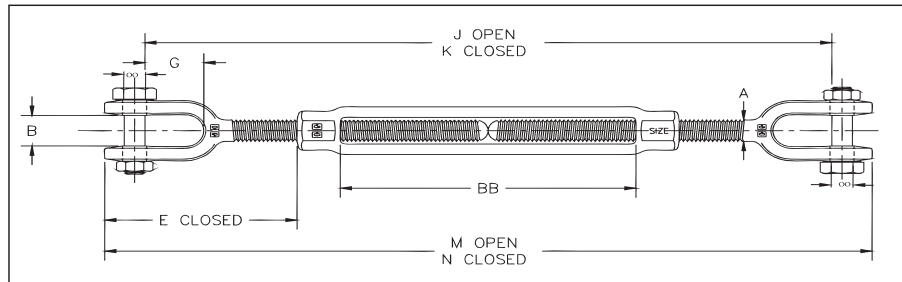

Rigging Accessories



### HG-228 Jaw & Jaw

Thread Dia. & Take Up (in)	HG-228 Stock No.	Working Load Limit (lb)*	Weight Each (lb)	Dimensions (in)									
				A	B	E Closed	G	J Open	K Closed	M Open	N Closed	BB	
† 1/4 x 4	1032493	500	.37	.25	.45	1.66	.64	11.19	7.19	12.18	8.18	4.07	
† 5/16 x 4-1/2	1032518	800	.56	.31	.50	2.02	.87	13.07	8.57	14.12	9.62	4.58	
† 3/8 x 6	1032536	1200	.85	.38	.53	2.11	.85	16.25	10.25	17.50	11.50	6.10	
1/2 x 6	1032554	2200	1.82	.50	.64	3.22	1.07	18.65	12.65	20.14	14.14	6.03	
1/2 x 9	1032572	2200	2.29	.50	.64	3.20	1.07	24.94	15.94	26.43	17.43	9.36	
1/2 x 12	1032590	2200	2.71	.50	.64	3.20	1.07	30.94	18.94	32.43	20.43	12.36	
5/8 x 6	1032616	3500	3.21	.63	.79	3.90	1.32	19.74	13.74	21.82	15.82	6.03	
5/8 x 9	1032634	3500	3.95	.63	.79	3.89	1.32	26.08	17.08	28.16	19.16	9.39	
5/8 x 12	1032652	3500	4.58	.63	.79	3.89	1.32	32.08	20.08	34.16	22.16	12.39	
3/4 x 6	1032670	5200	4.80	.75	.97	4.71	1.52	21.09	15.09	23.68	17.68	6.13	
3/4 x 9	1032698	5200	5.85	.75	.97	4.68	1.52	27.49	18.49	30.08	21.08	9.59	
3/4 x 12	1032714	5200	6.72	.75	.97	4.68	1.52	33.49	21.49	36.08	24.08	12.59	
3/4 x 18	1032732	5200	8.45	.75	.97	4.71	1.52	45.49	27.49	48.08	30.08	18.53	
7/8 x 12	1032750	7200	9.37	.88	1.16	5.50	1.77	34.65	22.65	37.62	25.62	12.16	
7/8 x 18	1032778	7200	11.8	.88	1.16	5.50	1.77	47.12	29.12	50.09	32.09	18.63	
1 x 6	1032796	10000	10.4	1.00	1.34	6.09	2.05	23.82	17.82	27.18	21.18	6.18	
1 x 12	1032812	10000	13.8	1.00	1.34	6.09	2.05	35.82	23.82	39.18	27.18	12.18	
1 x 18	1032830	10000	17.1	1.00	1.34	6.09	2.05	47.82	29.82	51.18	33.18	18.18	
1 x 24	1032858	10000	21.0	1.00	1.34	6.06	2.05	60.42	36.42	63.78	39.78	24.84	
1-1/4 x 12	1032876	15200	21.9	1.25	1.84	8.09	2.82	39.37	27.37	43.58	31.58	12.06	
1-1/4 x 18	1032894	15200	25.9	1.25	1.84	8.09	2.82	51.37	33.37	55.58	37.58	18.06	
1-1/4 x 24	1032910	15200	29.8	1.25	1.84	8.09	2.82	63.93	39.93	68.14	44.14	24.62	
1-1/2 x 12	1032938	21400	32.6	1.50	2.06	8.93	2.81	40.76	28.76	45.68	33.68	12.32	
1-1/2 x 18	1032956	21400	38.0	1.50	2.06	8.93	2.81	52.76	34.76	57.68	39.68	18.32	
1-1/2 x 24	1032974	21400	43.5	1.50	2.06	8.93	2.81	65.38	41.38	70.30	46.30	24.94	
1-3/4 x 18	1033018	28000	53.5	1.75	2.60	9.36	3.35	53.35	35.35	59.16	41.16	18.37	
1-3/4 x 24	1033036	28000	61.1	1.75	2.60	9.36	3.35	65.35	41.35	71.16	47.16	24.37	
2 x 24	1033054	37000	96.3	2.00	2.62	11.80	3.74	69.64	45.64	76.72	52.72	24.48	
2-1/2 x 24	1033072	60000	167	2.50	3.06	13.26	4.44	72.97	48.97	82.18	58.18	24.60	
2-3/4 x 24	1033090	75000	199	2.75	3.69	14.92	4.19	74.75	50.75	85.50	61.50	24.65	

\*Proof Load is 2.5 times the Working Load Limit. Ultimate Load is 5 times the Working Load Limit. † Mechanical Galvanized

### HOOKS & SWIVELS

### Crosby® Swivels



#### Equipped with Tapered Roller Thrust Bearing

- Suitable for frequent rotation under load.
- All swivels individually proof tested with labeled documentation.
- All hooks furnished with latches assembled.
- All jaws complete with bolts, nuts and cotter pins.
- Pressure lube fitting provided.
- NOT TO BE USED ON DEMOLITION (WRECKING) BALLS.
- Other types and capacities up to 1250t, available to meet your requirements.
- IMPORTANT - Crosby Swivels should only be used with the recommended wire rope. Contact the wire rope manufacturer for the proper wire rope to be used with Crosby Swivels.



QUIC-CHECK®



#### S-1 Jaw & Hook

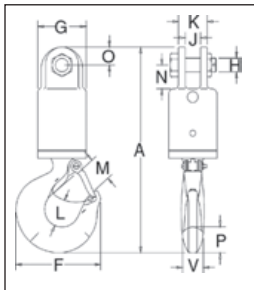

Swivel No.	S-1 Stock No.	Working Load Limit (t)*	Wire Rope Size (mm)	Weight Each (kg)	Dimensions (mm)											
					A	F	G	H	J	K	L	M	N	O	P	V
3-S-1	297011	3	13	4.45	291	123	70.0	19.1	22.4	41.1	38.9	35.8	33.3	25.4	36.6	28.4
5-S-1	297217	5	16	7.04	339	160	76.0	22.4	25.4	57.0	49.3	42.9	41.1	28.4	46.0	36.6
8-S-1	297413	8-1/2	19	13.3	418	192	102	25.4	39.5	71.5	62.5	56.5	54.0	35.1	57.0	41.1
10-S-1	297618	10	22	21.2	502	212	114	38.1	44.5	86.0	66.0	61.0	89.0	44.5	66.0	49.3
15-S-1	297814	15	26	33.5	565	263	127	38.1	44.5	86.0	71.5	81.0	89.0	44.5	76.0	60.5
25-S-1	298118	25	-	64	680	346	152	51.0	51.0	117	87.5	92.0	93.5	60.5	93.0	76.0
35-S-1	298216	35	-	100	760	357	165	51.0	51.0	117	98.5	95.5	93.5	60.5	116	81.0
45-S-1	298314	45	-	114	891	392	178	57.0	63.5	127	121	108	102	76.0	129	82.5

\*Individually Proof Tested to 2 times the Working Load Limit. Ultimate Load is 5 times the Working Load Limit.

#### S-2 Jaw & Jaw

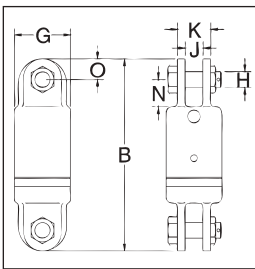

Swivel No.	S-2 Stock No.	Working Load Limit (t)*	Wire Rope Size (mm)	Weight Each (kg)	Dimensions (mm)						
					B	G	H	J	K	N	O
3-S-2	297020	3	13	4.37	236	70.0	19.1	22.4	41.1	33.3	25.4
5-S-2	297226	5	16	6.21	262	76.0	22.4	25.4	57.0	41.1	28.4
8-S-2	297422	8-1/2	19	11.9	321	102	25.4	39.5	71.5	54.0	35.1
10-S-2	297627	10	22	20.8	426	114	38.1	44.5	86.0	89.0	44.5
15-S-2	297823	15	26	28.5	435	127	38.1	44.5	86.0	89.0	44.5
25-S-2	298127	25	-	64	527	152	51.0	51.0	117	93.5	60.5
35-S-2	298225	35	-	70	527	165	51.0	51.0	117	93.5	60.5
45-S-2	298323	45	-	107	641	178	57.0	63.5	127	102	76.0

\*Individually Proof Tested to 2 times the Working Load Limit. Ultimate Load is 5 times the Working Load Limit.

#### S-3 Jaw & Eye

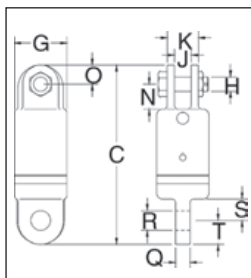

Swivel No.	S-3 Stock No.	Working Load Limit (t)*	Wire Rope Size (mm)	Weight Each (kg)	Dimensions (mm)										
					C	G	H	J	K	N	O	Q	R	S	T
3-S-3	297039	3	13	4.14	237	70.0	19.1	22.4	41.1	33.3	25.4	19.1	26.2	28.4	31.8
5-S-3	297235	5	16	6.12	256	76.0	22.4	25.4	57.0	41.1	28.4	25.4	32.5	31.8	31.8
8-S-3	297431	8-1/2	19	11.3	311	102	25.4	39.5	71.5	54.0	35.1	31.8	35.8	41.1	38.1
10-S-3	297636	10	22	19.7	409	114	38.1	44.5	86.0	89.0	44.5	42.9	42.9	70.0	47.8
15-S-3	297832	15	26	27.7	425	127	38.1	44.5	86.0	89.0	44.5	49.3	51.5	70.0	54.0
25-S-3	298136	25	-	61	546	152	51.0	51.0	117	93.5	60.5	57.0	58.5	98.5	60.5
35-S-3	298234	35	-	68	546	165	51.0	51.0	117	93.5	60.5	57.0	58.5	98.5	60.5
45-S-3	298332	45	-	102	657	178	57.0	63.5	127	102	76.0	63.5	64.5	102	76.0

\*Individually Proof Tested to 2 times the Working Load Limit. Ultimate Load is 5 times the Working Load Limit.

## Crosby® SHUR-LOC® Hooks



**S-1326**  
SWIVEL HOOK

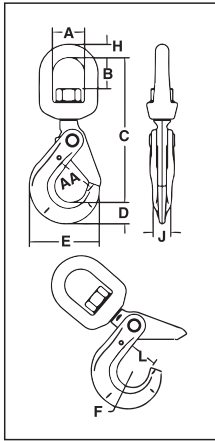

- Forged Alloy Steel - Quenched and Tempered.
- Individually Proof Tested at 2-1/2 times the Chain Working Load Limit with certification
- Recessed trigger design is flush with the hook bod , protecting the trigger from potential damage.
  - Easy to operate with enlarged thumb access.
- Positive Lock Latch is Self-Locking when hook is loaded.
- Rated for both Wire Rope and use with Grade 80/100 Chain or G-411 Standard Th
- G-414 Heavy Thimble or G-411 Standard Thimble should be used with wire rope slings.
- Trigger Repair Kit available (S-4316). Consists of spring, roll pin and trigger.
- S-13326 Swivel Hook utilizes anti-friction bearing design which allows hook to rotate freely under load.
- Fatigue rated.
- The SHUR-LOC® hook, if properly installed and locked, can be used for personnel lifting applications and meets the intent of OSHA Rule 1926.1431(g)(1)(i)(A) and 1926.1501(g)(4)(iv)(B).
- "Look for the Platinum Color – Crosby Grade 100 Alloy Products."



**S-13326**  
SWIVEL HOOK  
with BEARING

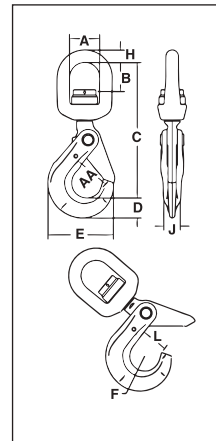

Hooks & Swivels

**Crosby 8/10™**

**QT**

CE

**Fatigue Rated**



Use in corrosive environment requires shank and nut inspection in accordance with ASME B 30.10-1.10.4 (b)(5)(c) 2019. The S-1326 hook is a positioning device and is not intended to rotate under load. For swivel hook designed to rotate under load, use the S-13326.

S-1326 SHUR-LOC® Swivel Hooks • Suitable for infrequent, non-continuous rotation under load.

Chain Size		Grade 100 Alloy Chain Working Load Limit (t) 4:1*	Working Load Limit (t) 5:1*	S-1326 Stock No.	Weight Each (kg)	Dimensions (mm)									
(in)	(mm)					A	B	C	D	E	F	H	J	L	AA**
-	6	1.45	1.16	1004304	.57	38.1	33.5	156	20.1	66.0	17.0	12.7	16.0	28.7	38.1
1/4 - 5/16	7-8	2.59	2.1	1004313	1.18	44.5	40.4	193	27.9	88.9	22.1	16.0	20.6	35.1	51.0
3/8	10	3.99	3.2	1004322	2.13	50.8	43.9	224	29.7	112	27.9	19.1	23.9	44.5	63.5
1/2	13	6.80	5.4	1004331	3.92	63.5	60.5	284	42.4	139	32.0	25.4	29.5	53.6	76.2
5/8	16	10.3	8.2	1004340	7.71	69.9	64.3	328	51.8	167	38.1	28.7	38.1	63.2	89.0
3/4	18 - 20	16.0	12.8	1004349	10.9	71.9	64.0	358	56.4	197	51.1	27.9	51.6	89.4	127
7/8	22	20.0	16.0	1004358	13.2	87.4	81.0	417	62.2	222	57.4	33.0	55.9	97.3	152

\*Ultimate Load is 4 times the Working Load Limit. \*\* Deformation Indicators.

S-13326 SHUR-LOC® Swivel Hooks with Bearing • Suitable for frequent rotation under load.

Chain Size		Grade 100 Alloy Chain Working Load Limit (t) 4:1*	Working Load Limit (t) 5:1*	S-13326 Stock No.	Weight Each (kg)	Dimensions (mm)									
(in)	(mm)					A	B	C	D	E	F	H	J	L	AA**
-	6	1.45	1.16	1004404	.57	38.1	29.0	157	20.1	66.0	17.0	12.7	16.0	28.7	38.1
1/4 - 5/16	7-8	2.59	2.1	1004413	1.18	44.5	38.6	192	27.9	89.0	22.1	16.0	20.6	35.1	51.0
3/8	10	3.99	3.2	1004422	2.13	51.0	40.9	226	29.7	112	27.9	19.1	23.9	46.5	63.5
1/2	13	6.80	5.4	1004431	3.92	63.5	51.6	282	42.4	138	32.0	25.4	29.5	53.5	76.2
5/8	16	10.3	8.2	1004440	7.71	70.0	50.3	328	52.0	167	38.1	28.7	38.1	63.0	89.0

\* Ultimate Load is 4 times the Working Load Limit. \*\* Deformation Indicators.

## McKissick® Snatch Blocks

### SHACKLE FITTING, SINGLE SHEAVE, 2-12t



419



L-170



L-160



417

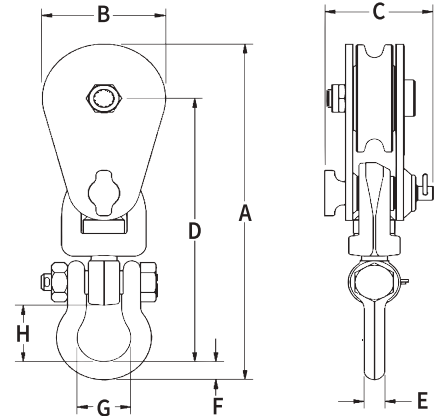

- Opening feature permits easy insertion of rope without reeving, or while the block is suspended.
- Bolt for opening feature is retained, to ensure no lost bolts.
- Forged steel swivel tees, yokes and shackles.
- Can be furnished with bronze bushings or roller bearings.
- Center pin equipped with pressure lube fitting.
- All sizes feature sheave grooves suited for a range of wire line diameters.
- Meets or exceeds all requirements of ASME B30.26 including identification ductility, design factor, proof load and temperature requirements. Importantly, these blocks meet other critical performance

requirements including fatigue life and material traceability, not addressed by ASME B30.26.

- "All Alloy" snatch blocks feature a significant reduction in weight compared to snatch blocks made of non-alloy materials.
- "Lebus, General Purpose" snatch blocks (with shackle or hook) feature an easy-to-open bolt design. The retaining bolt is released by rotating the fitting assembly, no tools required.
- Crosby's Engineered Solutions Group is ready to discuss your requirements and help select or develop the ideal block for your application. Call us at 1-800-777-1555.

Working Load Limit (t)*	Wire Rope Size (mm)	Sheave Diameter (mm)	Bearing Code	Weight Each (kg)	Catalog No.	Description	Stock No.	Dimensions (mm)							
								A	B	C	D	E	F	G	H
2 tonnes															
2	8 - 10	76	BB	1.8	419 w/Eye	Light Champion	109037†	220	76	67	168	14	14	35	35
2	8 - 10	76	BB	2.3	419	Light Champion	109091	235	76	67	185	13	13	34	40
4 tonnes															
4	10 - 13	114	BB	5.4	419	Light Champion	109064	340	108	79	268	16	18	43	51
5 tonnes															
5	10 - 13 ‡	102	BB	5.0	L-170	Lebus, General Purpose	599828	353	114	75	278	16	18	43	51
5	10 - 13 ‡	102	RB	5.0	L-170	Lebus, General Purpose	599837	353	114	75	278	16	18	43	51
6 tonnes															
6**	10 - 13	127	BB	5.9	L-160	Lebus, Heavy Duty	599524	351	130	94	268	16	18	43	51
6**	10 - 13	127	RB	5.9	L-160	Lebus, Heavy Duty	599533	351	130	94	268	16	18	43	51
8 tonnes															
8	16 - 19	152	BB	12.7	419	Light Champion	109126	481	152	106	373	32	32	76	88
8	16 - 19	152	RB	12.7	419	Light Champion	109153	481	152	106	373	32	32	76	88
8	16 - 19	203	BB	15.0	419	Light Champion	109224	533	206	106	398	32	32	76	88
8	16 - 19	203	RB	15.0	419	Light Champion	109251	533	206	106	398	32	32	76	88
8	16 - 19	254	BB	19.5	419	Light Champion	109322	586	257	106	425	32	32	76	88
8	16 - 19	254	RB	19.5	419	Light Champion	109359	586	257	106	425	32	32	76	88
8	16 - 19	305	BB	24.9	419	Light Champion	109420	657	308	106	471	32	32	76	88
8	16 - 19	305	RB	24.9	419	Light Champion	109457	657	308	106	471	32	32	76	88
8	16 - 19	356	BB	30.4	419	Light Champion	109527	695	359	106	484	32	32	76	88
8	16 - 19	356	RB	30.4	419	Light Champion	109545	695	359	106	484	32	32	76	88
12 tonnes															
12**	16 - 19	146	BB	13.2	L-160	Lebus, Heavy Duty	599588	483	152	106	375	32	32	76	88
12**	16 - 19	146	RB	13.2	L-160	Lebus, Heavy Duty	599597	483	152	106	375	32	32	76	88
12	19 - 22	152	BB	12.7	417	All Alloy	168972	481	152	106	373	32	32	76	88
12	19 - 22	152	RB	12.7	417	All Alloy	193757	481	152	106	373	32	32	76	88
12	19 - 22	203	BB	15.4	417	All Alloy	168990	533	206	106	398	32	32	76	88
12	19 - 22	203	RB	15.4	417	All Alloy	193819	533	206	106	398	32	32	76	88
12	19 - 22	254	BB	19.1	417	All Alloy	193882	586	257	106	425	32	32	76	88
12	19 - 22	254	RB	19.1	417	All Alloy	193935	586	257	106	425	32	32	76	88

\* Ultimate Load is 4 times the Working Load Limit. \*\* Ultimate Load is 3.5 times the Working Load Limit. † Fitted with 1-1/4" ID Swivel Eye. ‡ Special Dual Groove Sheave also accepts 1-1/4" Manilla Rope.

## McKissick® Oilfield Servicing Blocks



**M-491**  
Tower Hoist Block

New design provides the dependability of standard McKissick® Snatch Blocks, along with features that make it perfect for the challenging needs of Tugger Hoist and Tower Erection applications.

- A wide variety of configurations
  - 4, 8, 12, 15, 25 or 30 metric ton capacity
  - 10, 13, 16, 19, 22, 25 and 32mm Wireline sizes
  - Painted or Galvanized finish
- 203mm and 254mm blocks furnished with dual rated Wireline sheaves.
- Forged steel swivels, tees, yokes and shackles are Quenched & Tempered.
- Sheave lubrication through center pin for easy maintenance.
- Design factor of 4:1.
- All blocks 356mm and larger are furnished with McKissick® Roll Forged sheaves with flame hardened grooves
- Recessed sideplate design reduces the gap between the sheave rim and the sideplate, allowing the sheave assembly to be captured in the block if loss of center pin occurs.
- Sealed tapered roller bearings extend the life of the center pin and bearings, and allows for faster line speeds than recommended with standard snatch blocks.
- Shackle fitting swivels for easy positioning
- Suitable for hoisting personnel, contingent upon all employees, including the winch operator, being trained to follow applicable Federal, local and industry standards.
  - Tugger/Derrick applications: API RP54
  - Tower applications: OSHA directive CPL 2-1.36
- Holes through side plates are available for secondary block securement device.
- Manufactured by an API Q1 Certified facility .
- Type Approval and certification in accordance with ABS 2015 Steel Vessel Rules 1-1-17.7, and ABS Guide for Certification of Cranes
- All sizes are **RFID EQUIPPED**.



**M-491G**  
Derrick Hoist Block



### M-491 / M-491G Tower/Derrick Hoist Blocks

Working Load Limit (t)*	Sheave Diameter (mm)	Wireline Size (mm)	M-491S Stock No. Painted	M-491G Stock No. Galvanized	Weight Each (kg)
4	203	10 - 13	2020161	2020170	16
8	254	10 - 13	2020806	2020815	25
8	254	13 - 14	2020824	2020833	25
12	254	13 - 14	2021118	2021127	25
12	356	16	2021136	2021145	43
12	356	19	2021154	2021163	43
15	406	22	2021172	2021181	68
15	406	25	2021190	2021199	48
25	457	28.6	2032312	2032315	118
30	508	32	2032321	2032324	306

\* Ultimate Load is 4 times the Working Load Limit.

Contact our our Block Hotline (1-800-727-1555) for larger blocks up to 350 tonnes or reference the special request form on page 485.